



Crafting Excellence in
Edge Band and Hardware Solutions



- PVC Edge Banding Tape
- Telescopic Channels
- PVC Foam Board
- Hydraulic Hinges
- WPC Door Frames
- PVC Moulding



About Us

Established in 2011, Durawell has been a trusted name in the manufacturing industry, starting with high-quality PVC Foam Boards that have set the standard in the market. Over the years, we have expanded our expertise and product offerings to meet the evolving needs of our customers. In 2016, we introduced our range of Edge Banding Tapes, designed to provide seamless finishes and enhanced durability for furniture and interior applications. Recognising the demand for reliable hardware, we ventured into the production of Drawer Slides in 2018, offering precision-engineered solutions that ensure smooth, dependable movement for drawers and other sliding mechanisms. Continuing our tradition of innovation and quality, we have recently diversified into the production of WPC Door Frames and PVC Moulding, further broadening our portfolio to provide comprehensive solutions for both residential and commercial projects. At Durawell, our commitment to excellence drives everything we do. We blend advanced manufacturing techniques with a deep understanding of our customers' needs, delivering products that are not only durable but also aesthetically pleasing and functional. With a decade of experience and a focus on continuous improvement, we remain dedicated to providing superior products that meet the highest standards of quality and reliability.

INDEX

PVC EDGE BANDING TAPE	6 - 7
-----------------------	-------

DRAWER SLIDES	8 - 9
---------------	-------

HYDRAULIC HINGE	10 - 11
-----------------	---------

PVC FOAM BOARD	12
----------------	----

PVC DOORS	13
-----------	----

WPC DOOR FRAME	14
----------------	----

PVC MOUDLING	15
--------------	----



Our Journey

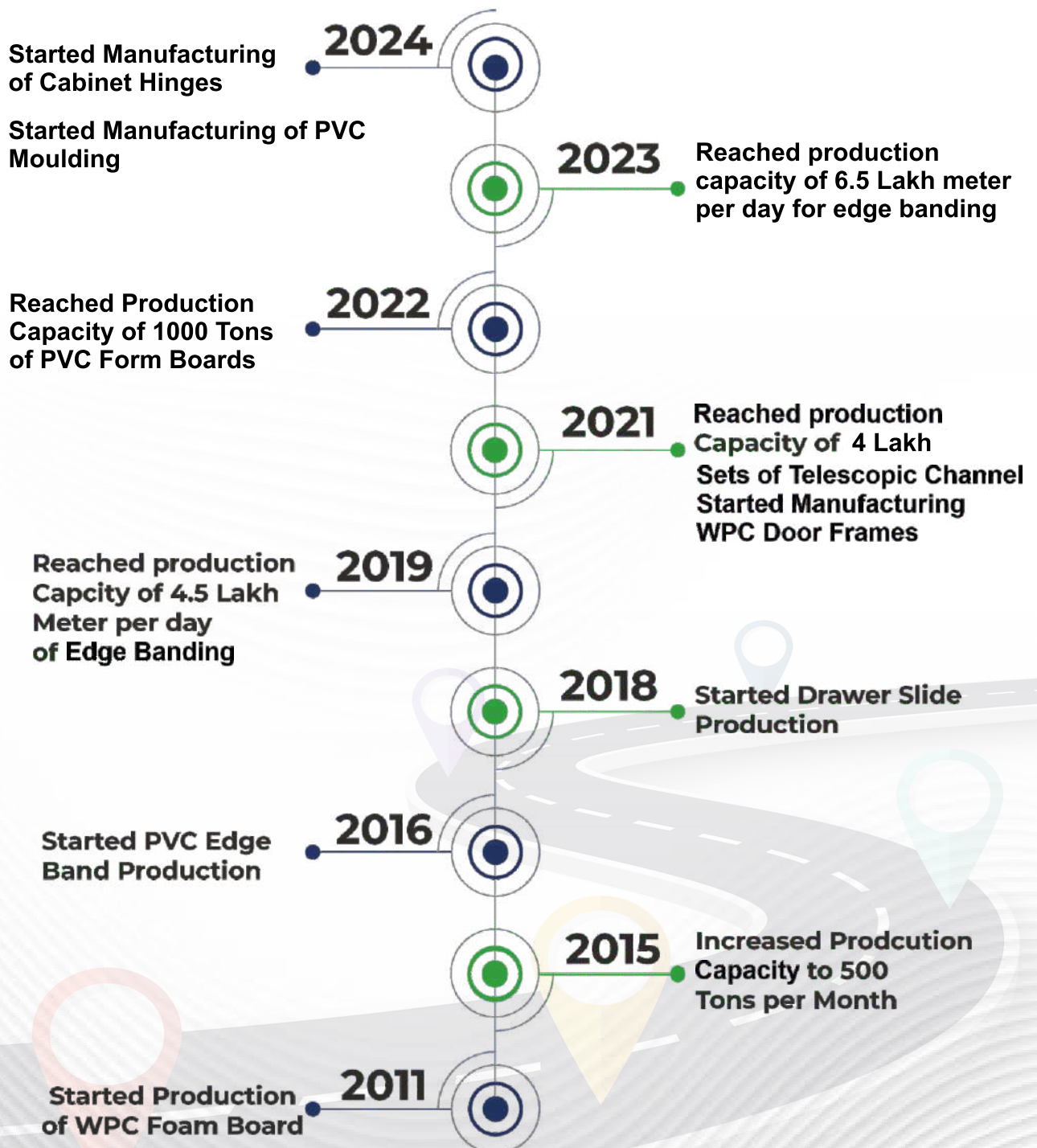



Glimpses of our **manufacturing** facility

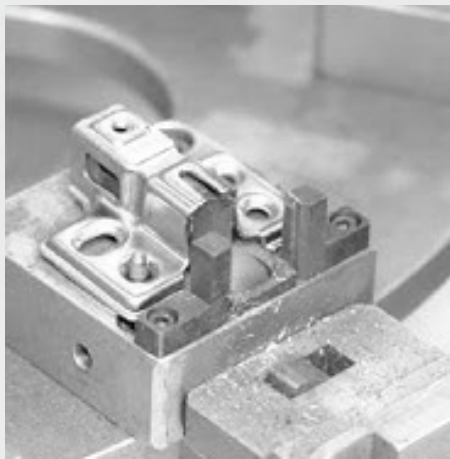



PVC EDGE BANDING TAPE

Durawell PVC edge banding tape is the premier choice for high-quality and durable edge finishes on furniture and cabinetry. Available in a wide range of colors, patterns, and finishes, Durawell not only enhances the visual appeal of your products but also provides robust protection against moisture, impacts, and daily wear. Trust Durawell for a seamless, professional finish that ensures long-lasting beauty and performance.

Salient Features



Superior Durability



Excellent Adhesion



Aesthetic Versatility



UV Resistance



Chemical Resistance



Flexibility



Thermal Stability



Ease of Application



Smooth Finish



Customizability



No Whiteness on Trimming



Standard Size

Thickness	0.8mm	2mm	1.3mm	0.45mm
Width	22mm, 25mm,30mm,45mm		22mm	
Roll Length	25Meters , 50 Meters			
Shade Range	Solid, Wooden, Metallic, Fabric, Marble & Stones			
Finish	Super Matt, High Gloss, Sparkless, Soft Touch & Acylic (Only in 1.3mm)			

- Roll Length can be customised for bulk orders.

Properties

Description	Unit	Value	Standard
Hardness Shone	-	D-78 ± 4	ISO 868
Shrinkage [1h at 140°F (60°C)]	%	<0.5	Work Stand
Stalic Charging	-	Low	-
Vicat Softtening Temperature (At 50N)	°C	80.3	ASTM D1525-2009

Colour Fastness to Rubbing

(a) At Dry Staining	Rating	4/5	IS:766-1988
(b) At wet Staining	Rating	4/5	IS:766-1988

Colour Fastness to Light

(a) Type of lamp	UV A340	No Cracks or Blister Observed	AS TN G154-2016
(b) Exposure Time	24 Hour	No Cracks or Blister observed	ASTN G1 54-2016

Resistance to Cigarette Burn

Appearance	Rating	4	1S:2046-1995
------------	--------	---	--------------



Manufacturer of Edge Banding Tape in India



DRAWER SLIDES

At Durawell, we are engaged in manufacturing of high quality, durable, and smoothly operating Drawer Slides. Our precision-engineered products are designed to enhance the functionality and longevity of your furniture and storage solutions. Explore our range and experience the perfect blend of strength, reliability, and seamless performance.

SALIENT FEATURES:-

- Full Extension Ball Bearing Slides
- Noise Free Operation
- 75000 Cycles Tested
- Extra Hard Ball Bearing
- Made with German Technology
- Salt Spray Tested for long life operation

Smooth as silk,
Every time you slide.

45KG FULL EXTENSION DRAWER SLIDE



45



Kg Load Capacity

96h

SALT SPRAY TESTED



75000 Life Cycle Tested

Product Code	Full Extension Length
DW-NONC-4545-10-XX	250mm
DW-NONC-4545-12-XX	300mm
DW-NONC-4545-14-XX	350mm
DW-NONC-4545-16-XX	400mm
DW-NONC-4545-18-XX	450mm
DW-NONC-4545-20-XX	500mm
DW-NONC-4545-22-XX	550mm
DW-NONC-4545-24-XX	600mm

35KG FULL EXTENSION DRAWER SLIDE



35



Kg Load Capacity

96h

SALT SPRAY TESTED



75000 Life Cycle Tested

Product Code	Full Extension Length
DW-NONC-4535-10-XX	250mm
DW-NONC-4535-12-XX	300mm
DW-NONC-4535-14-XX	350mm
DW-NONC-4535-16-XX	400mm
DW-NONC-4535-18-XX	450mm
DW-NONC-4535-20-XX	500mm
DW-NONC-4535-22-XX	550mm
DW-NONC-4535-24-XX	600mm

45KG SOFT CLOSE DRAWER SLIDE



45



Kg Load Capacity

96h

SALT SPRAY TESTED



75000

Life Cycle Tested

Product Code	Full Extension Length
DW-NOSC-4545-10-XX	250mm
DW-NOSC-4545-12-XX	300mm
DW-NOSC-4545-14-XX	350mm
DW-NOSC-4545-16-XX	400mm
DW-NOSC-4545-18-XX	450mm
DW-NOSC-4545-20-XX	500mm
DW-NOSC-4545-22-XX	550mm
DW-NOSC-4545-24-XX	600mm

35KG SOFT CLOSE DRAWER SLIDE



35



Kg Load Capacity

96h

SALT SPRAY TESTED



75000 Life Cycle Tested

Product Code	Full Extension Length
DW-NOSC-4535-10-XX	250mm
DW-NOSC-4535-12-XX	300mm
DW-NOSC-4535-14-XX	350mm
DW-NOSC-4535-16-XX	400mm
DW-NOSC-4535-18-XX	450mm
DW-NOSC-4535-20-XX	500mm
DW-NOSC-4535-22-XX	550mm
DW-NOSC-4535-24-XX	600mm

*XX Refers to Finish Option (ZN for Zinc and BK for Black)





Crafting

COMFORT
IN EVERY TURN



HYDRAULIC HINGE

Durawell hydraulic hinges are designed for superior performance and long-lasting durability. Crafted from high-quality materials, these hinges ensure smooth operation and secure closure for all types of cabinets. Durawell hinges seamlessly blend with any decor, providing both functionality and aesthetic appeal. Ideal for kitchen, bathroom, and office cabinetry, Durawell hinges are the perfect choice for any renovation or new construction project. Experience the difference with Durawell - where quality meets elegance.

Salient Features:-

-  **Durability**
-  **Smooth Operation**
-  **Corrosion Resistance**
-  **Adjustability**
-  **Soft-Close Mechanism**
-  **Aesthetic Appeal**
-  **Easy Installation**
-  **Maintenance-Free**

Mild Steel 3D Adjustable Hinge



72h SALT
SPRAY
TESTED

100000
Life Cycle
Tested

Product Code	Installation Style
DW-CH-MSH-3D-0	Full Overlay
DW-CH-MSH-3D-8	Half Overlay
DW-CH-MSH-3D-15	Inset

Stainless Steel 3D Adjustable Hinge



72h SALT
SPRAY
TESTED

100000
Life Cycle
Tested

Product Code	Installation Style
DW-CH-SSH-3D-0	Full Overlay
DW-CH-SSH-3D-8	Half Overlay
DW-CH-SSH-3D-15	Inset

Mild Steel 2D Adjustable Hinge



72h SALT
SPRAY
TESTED

100000
Life Cycle
Tested

Product Code	Installation Style
DW-CH-MSH-2D-0	Full Overlay
DW-CH-MSH-2D-8	Half Overlay
DW-CH-MSH-2D-15	Inset

Stainless Steel 2D Adjustable Hinge



72h SALT
SPRAY
TESTED

100000
Life Cycle
Tested

Product Code	Installation Style
DW-CH-SSH-2D-0	Full Overlay
DW-CH-SSH-2D-8	Half Overlay
DW-CH-SSH-2D-15	Inset

Cabinet Door Installation Selection

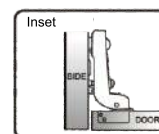
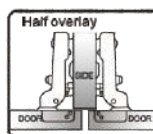
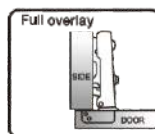

Adjustment Method

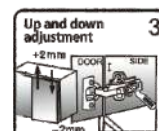
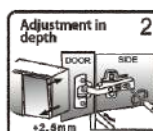
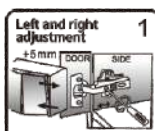

*Only Available in 3D Adjustable Model



Durawell PVC Foam Board is the most preferred material used in modern architecture. Its high usability, water resistance, and weather resistance make this a good replacement for wood.

Why CHOOSE

duraWELL PVC board over Wood Based Panel?



EASY TO CUT

Durawell PVC Board can be cut, sawed, screwed, engraved and drilled with circular saw or with traditional carpenter AARI. Due to this feature, DURA WELL PVC board can be used to design any furniture of any shape.



FIRE RETARDANT

Durawell PVC board is fire retardant panel as it does not help to spread fire so it can be used in public places. kitchen, offices etc



WATER GUARANTEE

Durawell PVC board is completely safe to use in any application even you can use it in swimming pool. It is manufactured with water proof material which keeps it unchanged in any adverse conditions



TOUCH INSIDE SMOOTHER OUTSIDE

Durawell PVC board is manufactured virgin materials which is eco-friendly and high density. Due to this high density material PVC board has high density inside and so it does not bend and twist in any adverse condition



HIGH LOAD BEARING STRENGTH

Durawell PVC board has high load bearing strength, which makes it perfect for insulation, display boards and furnishing.



TERMITES AND BOARD PROOF PANEL

Since Durawell PVC board is manufactured with such type of materials which is naturally immune against termite and borer so there is no chance of termites and borer in DURA WELL PVC board.

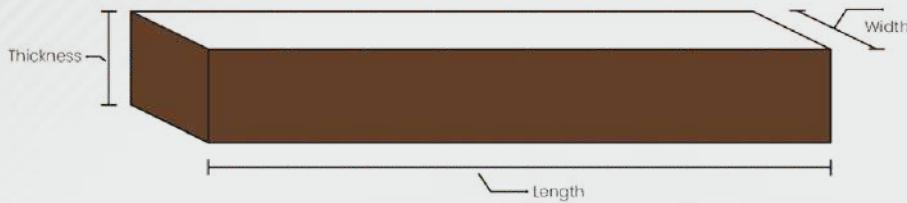

Standard Technical Specification

Length x Width	: 8ft x 4ft
Thickness	: 4mm 6mm 8mm 9mm 11mm 12mm 17mm 18mm 25mm
Density (g/cm ³)	: 0.400, 0.450, 0.500, 0.550, 0.600
Colour	: White, Ivory and Grey

* Size, Thickness, Colour and Density can be customised according to customer requirements

PVC DOORS

Our range of PVC DOORS offers the ideal combination of strength and functionality for both residential and commercial spaces. Engineered from high-quality polyvinyl chloride, these doors are resistant to weathering, moisture, and corrosion along with the added advantage of Termite proof and fire retardant. Our PVC DOORS are versatile in nature offering an extensive range of finishing options including Digital printing, Cold lamination, CNC routing, Gravure printing, and PU Paint, allowing them to be customized to perfectly match style and functional requirements

Standard Technical Specification

Length	: 6ft-9ft
Thickness	: 21 inches - 36 inches
Thickness	: 15mm 18mm 21mm 22mm 24mm 25mm 27mm 28mm 30mm
Density (g/cm ³)	: 0.400, 0.450, 0.500, 0.550, 0.600
Colour	: White, Ivory and Brown
Density (g/cm ³)	: 0.450, 0.500, 0.550, 0.600

* Size, Thickness, Colour and Density can be customised according to customer requirements

ONE PRODUCT MANY APPLICATIONS





**101% TERMITES,
BORER &
WATER PROOF
PVC BOARD**



WPC DOOR FRAME

Durawell WPC Door Frames are engineered to provide superior strength and lasting beauty. Made from a robust blend of wood and plastic, these frames offer exceptional resistance to moisture, termites, and environmental wear. Perfect for both residential and commercial spaces, our WPC Door Frames ensure long-lasting performance without compromising on style.

Choose Durawell WPC Door Frames for a sustainable, maintenance-free solution that enhances the aesthetics and durability of your spaces.



Advantages

- Easy Maintenance.
- Adaptability to different weather conditions.
- Solid structure with high tensile strength
- High screw and nail holding capacity
- Easy to install.
- Do not crack, deform or warp.
- Anti-corrosive

Available Sizes:

6X2.5 inch, 5X2.5 inch, 4X2.5 inch, 4X2 inch, 3X2 inch.



BORER & FUNGAL
PROOF



100% WATER
PROOF



HIGH SCREW HOLDING
CAPABILITY



TERMITE
PROOF

The perfect wood substitute

Discover the perfect blend of style and durability with our premium PVC Mouldings. Designed to elevate the aesthetics of any interior space, these mouldings offer a sophisticated solution for adding character and charm to your walls. Our mouldings are lightweight, easy to install, and resistant to moisture, making them ideal for both residential and commercial applications. Whether you're looking to create a classic, timeless look or a modern, sleek finish, our PVC Moulding provide the versatility you need to bring your vision to life.



STRENGTH AND DURABILITY

Unlike timber, our boards retain their strength and durability throughout their life.



NO ROTTING OR WARPING

A unique material composition resistant to the damaging effects of moisture build-up.



ECO-FRIENDLY

A long-lasting material composed of a blend of recycled plastic and wood fibres.



NO SPLINTERING

The material composition ensures long-term safety and assurance.



25 YEAR RESIDENTIAL WARRANTY High-quality, long-lasting products with a 25-year warranty.



VERY LOW MAINTENANCE

All our boards are hard-wearing and easy to maintain.

TECHNICAL INFORMATION

MATERIAL

High Density PS (99%)

DENSITY

440-590 kg/m

FLEXURAL STRENGTH

9,1+0,5 MPa (DIN53457)

HARDNESS

90 Shore D (DIN53505/ISO868)

OZONE DEPLETION FACTOR

Zero (CFC-Free, Waterblown)

MELTING TEMPERATURE

266-284 °F

IMPACT RESISTANCE (IZOD)

12 J/m (ASTM D 256-10)

MOISTURE-WATER ABSORPTION

0,09% (ASTM D 570-98)

HEAT RESISTANCE

Max. +158°F

INSTALLATION PROCESS

1



Prep-work with plaster board or plywood is recommended before the installation. Please remove wallpapers on the wallpaper on the walls before the installation.

2



Circular saw can be used for cutting.

3



Apply Nail Free Glue on the Back of wall panel.

4

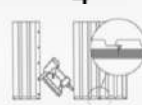

Wall Panels can be installed in both horizontal and vertical direction. Apply air-tracker on the edge of the tongue to hide the pin-marks.

5



For Corner, combine the two grooves.



**Edges and Slides Products India
Private Limited**

 www.durawell.co.in
 info@durawell.co.in

 Udhog Marg, Jind Road
Kaithal - 136027 Haryana, India



Follow us

